

Value Engineered Collectors

For Optimal Performance and Longevity

Low-iron transparent 1/8" tempered glass for radiant transmission and toughness

Highly selective coating maximizing absorption while minimizing radiant heat loss

Single aluminum full plate sheet absorber for maximum efficiency

Anodized aluminum extruded frame for strength and long life

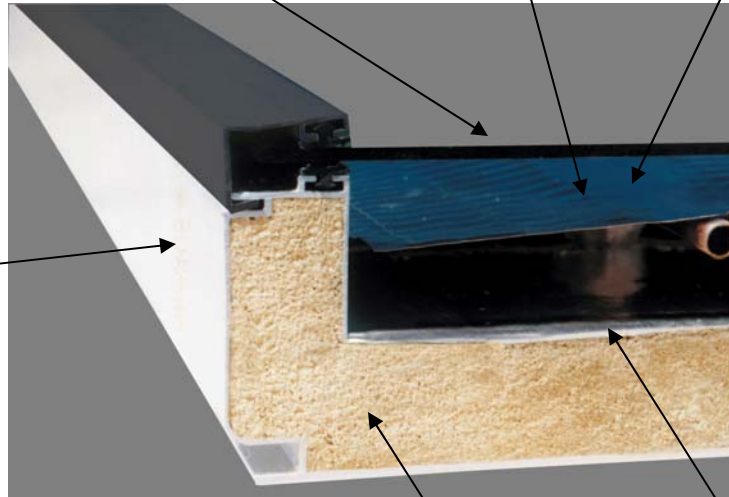

Laser welded vertical transport tubes for durability of the aluminum to copper bond

10 vertical copper tubes to maximize heat transfer from the collector

Thick polyurethane insulation with aluminum vapor shield for optimizing efficiency by reducing thermal losses

Competitors Example

- Multiple plates
- Not laser welded
- Sheet metal frame
- Fibrous insulation
- Thin side insulation

